

BOSTITCH®

RN46

COIL-FED PNEUMATIC ROOFING NAILER
CLAVADORA NEUMÁTICA ALIMENTADA POR ROLLO PARA TECHADO
CLOUEUR PNEUMATIQUE À ENROULEMENT POUR TOITURE

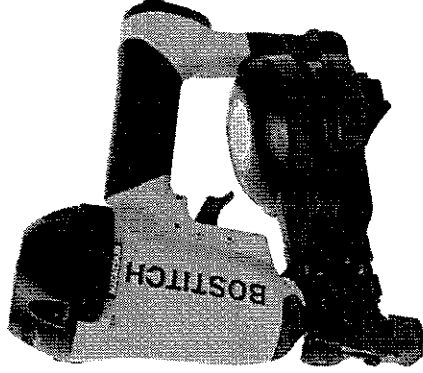

TOOL PARTS ILLUSTRATION ILUSTRACIÓN DE LAS PIEZAS DE LA HERRAMIENTA ILLUSTRATION DES PIÈCES D'OUTILLAGE

⚠ WARNING:

BEFORE PERFORMING REPAIRS ON THIS TOOL, ALL OPERATORS SHOULD STUDY THIS ILLUSTRATION, AS WELL AS THE PARTS LIST AND OPERATION AND MAINTENANCE MANUAL. OPERATORS SHOULD UNDERSTAND AND FOLLOW ALL SAFETY WARNINGS AND INSTRUCTIONS. KEEP THIS ILLUSTRATION WITH THE TOOL FOR FUTURE REFERENCE. IF YOU HAVE ANY QUESTIONS, CONTACT YOUR BOSTITCH REPRESENTATIVE OR DISTRIBUTOR.

⚠ ATTENTION:

ANTES DE LLEVAR A CABO CUALQUIER REPARACIÓN EN LA HERRAMIENTA, TODOS LOS OPERARIOS DEBERÁN ESTUDIAR ESTA ILLUSTRACIÓN, ASÍ COMO LA LISTA DE PIEZAS Y EL MANUAL DE OPERACIÓN Y MANTENIMIENTO. LOS OPERARIOS DEBERÁN ENTENDER Y SEGUIR TODAS LAS ADVERTENCIAS E INSTRUCCIONES DE SEGURIDAD. CONSERVE ESTA ILLUSTRACIÓN CON LA HERRAMIENTA PARA PODER CONSULTARLA EN LO FUTURO. SI TUVIERA ALGUNA PREGUNTA, PONGASE EN CONTACTO CON SU REPRESENTANTE O DISTRIBUIDOR DE BOSTITCH.

AVANT DE PROCÉDER À LA RÉPARATION DE CET OUTIL, LES OPÉRATEURS DOIVENT ÉTUDIER LA PRÉSENTE ILLUSTRATION AINSI QUE LA LISTE DE PIÈCES ET LE MANUEL D'INSTRUCTIONS ET D'ENTRETIEN ; ILS DOIVENT ÉGALEMENT COMPRENDRE ET OBSERVER LES CONSIGNES DE SÉCURITÉ ET LES INSTRUCTIONS. CONSERVER CETTE ILLUSTRATION AVEC L'OUTIL POUR RÉFÉRENCE FUTURE. SI VOUS AVEZ DES QUESTIONS, COMMUNIQUEZ AVEC VOTRE REPRÉSENTANT OU VOTRE DISTRIBUTEUR DE BOSTITCH.

IP1181-1REV F 10/04

BOSTITCH
Stanley Fastening Systems

RN46

COIL-FED PNEUMATIC ROOFING NAILER
CLAVADORA NEUMÁTICA ALIMENTADA POR ROLLO PARA TECHADO
CLOUEUR PNEUMATIQUE À ENROULEMENT POUR TOITURE

Item 62 available (Not Shown)
 Rebuild Kit RN46-RK
 Includes Items 4 thru 11, 13, 15, 17,
 18, 34, 36, 38, 50 & 61.

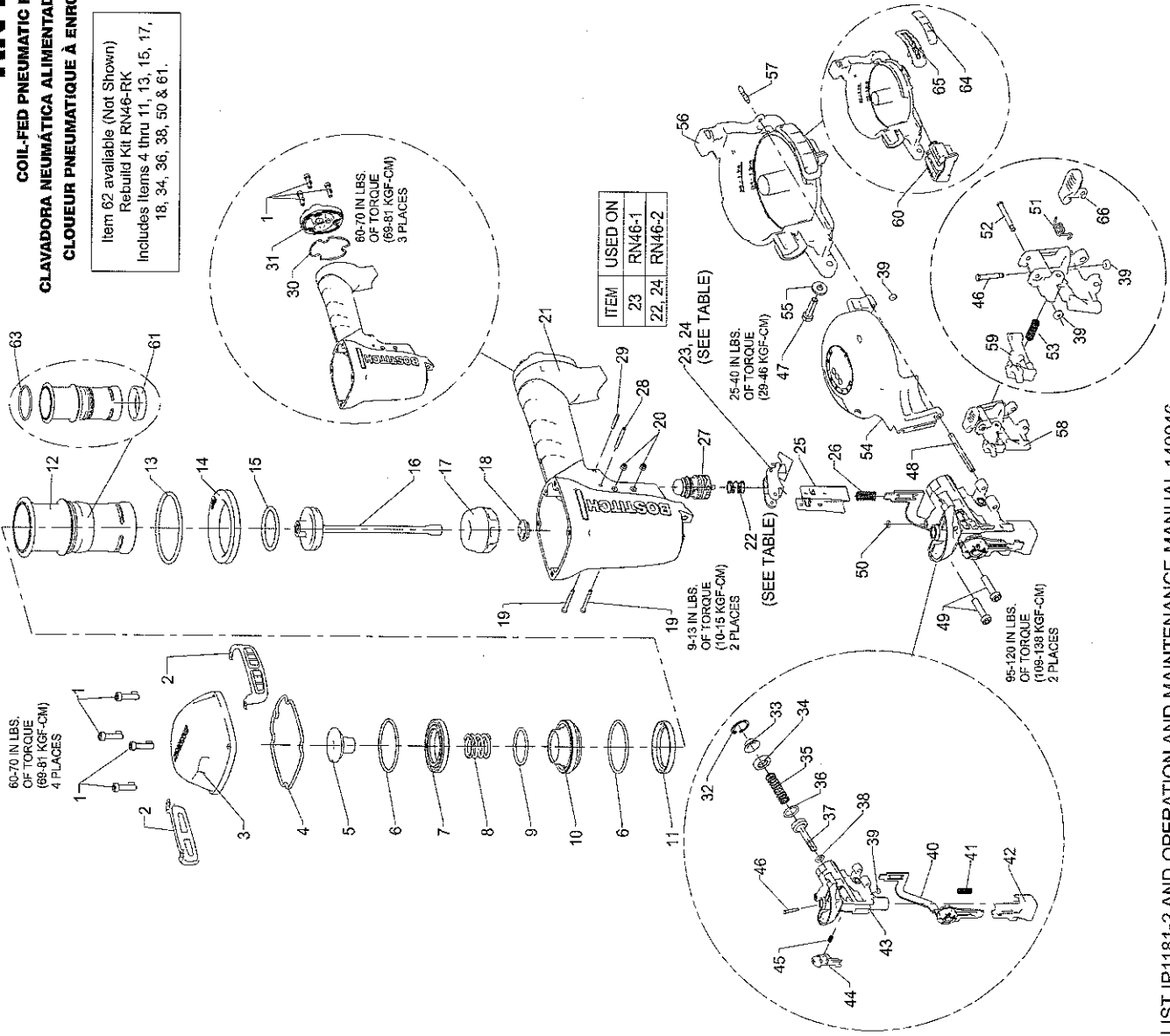

BOSTITCH

RN46		Parts List:		IP1181-2REVF	
To be Used with tool parts illustration: and operation and maintenance manual:					
				IP1181-1REVF	
				149946	
Serial Number on the Tool:				RN46 4317 000 and Higher	
ITEM	PART #	DESCRIPTION	ITEM	PART #	DESCRIPTION
1	MSC5080-20	SCREW,SOC HD. CAP M5 X 20	54	149943	ASSEMBLY,COVER/CANISTER
2	149845	ASSEMBLY,WEAR PLATE	55	MPW6.2	WASHER,SPECIAL
3	149808	CAP,MACHINING	56	149939	ASSEMBLY,CANISTER
4	149832	SEAL,FRAME/CAP	57	149907	PIN,COVER/CANISTER
5	149838	BUMPER,HEAD VALVE	58	160144	ASSEMBLY,DOOR
6	149828	O-RING,1.925X.103 XNBR	59	160142	PAWL,CHECK
7	149836	UPPER BODY,HEAD VALVE	60	149940	ASSEMBLY,SHINGLE GUIDE
8	149806	SPRING,HEAD VALVE	61	149812	SEAL,CHECK
9	149842	O-RING,1.299X.103 XNBR	62	RN46-RK	REBUILD KIT,RN46
10	149839	LOWER BODY,HEAD VALVE	63	149829	O-RING,1.862X.103 NBR
11	149840	SEAL,SLEEVE	64	149866	WEAR PAD,CANISTER
12	149941	ASSEMBLY,SLEEVE	65	161236	GUARD,CANISTER
13	850766	O-RING,2.609X.139	66	149861	LATCH
14	149814	RING,SLEEVE			
15	850607	O-RING,1.484X.139			
16	149826	ASSEMBLY,PISTON/DRIVER			
17	149803	BUMPER			
18	149820	GUIDE,DRIVER			
19	105811	SCREW,TRIGGER PIVOT			
20	MHE3050-100	NUT,NYLON M3X.50			
21	149830	ASSEMBLY,FRAME			
22	100387	SPRING,COMPRESSION			
23	107581	ASSEMBLY,C.T.TRIGGER			
24	107582	ASSEMBLY,S.T.TRIGGER			
25	107522	GUIDE,TRIP			
26	149871	SPRING,CONTACT ARM			
27	TVA6	KIT,TRIGGER VALVE			
28	100298	PIN,SPIRAL M3X30			
29	MPP030020	PIN,SPIRAL M3X20MM			
30	149816	SEAL,END CAP			
31	149817	CAP,END			
32	149854	RETAINING RING,INCH			
33	149853	COLLAR,SPRING			
34	149855	STOP,FEED PISTON			
35	149887	SPRING,FEED PISTON			
36	88998	O-RING,.674X.103			
37	149852	FEED,PISTON			
38	149883	O-RING,.299X.103 NBR			
39	N12112	HINGE PIN RETAINER			
40	149899	ASSEMBLY,TRIP			
41	149874	SPRING,DEPTH ADJUST CAM			
42	149900	ASSEMBLY,CONTACT ARM FOOT			
43	160143	ASSEMBLY,NOSE			
44	149897	PAWL,FEED			
45	149859	SPRING,FEED PAWL			
46	149882	PIN,CHECK PAWL			
47	MSC6100-25	SCREW,SHCS,M6X1.00X25			
48	149905	PIN,DOOR/COVER			
49	MSC6100-30	SCREW,SHCS,M6X1.00X30			
50	149885	O-RING,.145X.070 CP			
51	149831	SPRING,TORSION DOOR LATCH			
52	149886	PIN,DOOR LATCH			
53	149898	SPRING,CHECK PAWL			