

**ACCESSORIES AVAILABLE
ACCESORIOS DISPONIBLES
ACCESSOIRES DISPONIBLES**

- BC601 4 oz. Bostitch Air-Tool Lubricant
- BC602 1 pint Bostitch Air-Tool Lubricant
- BC603 1 pint Bostitch "Winter-Formula" Air-Tool Lubricant
- BC604 1 quart Bostitch Air-Tool Lubricant
- 851385 Loctite Grade 242 (.02 oz.)
- N80K2 Remote control kit
- N89ORK Kit, O-ring repair
- 171343 Shield, Dust, N89C
- 1134B-0864701 Plug, Dust Shield

BOSTITCH®

N89C-1P

**COIL-FED PNEUMATIC FRAMING NAILER
CLAVADORA NEUMÁTICA ALIMENTADA POR ROLLO
CLOUEUR PNEUMATIQUE À ENROULEMENT**

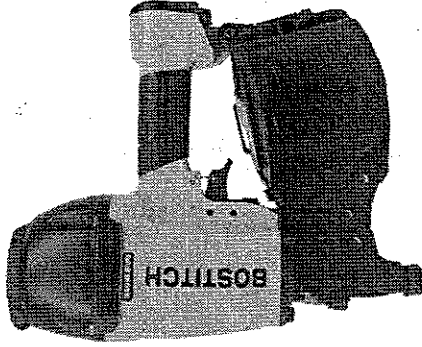

**TOOL PARTS ILLUSTRATION
ILUSTRACIÓN DE LAS PIEZAS DE LA HERRAMIENTA
ILLUSTRATION DES PIÈCES D'OUTILLAGE**

▲WARNING:

BEFORE PERFORMING REPAIRS ON THIS TOOL, ALL OPERATORS SHOULD STUDY THIS ILLUSTRATION, AS WELL AS THE PARTS LIST AND OPERATION AND MAINTENANCE MANUAL. OPERATORS SHOULD UNDERSTAND AND FOLLOW ALL SAFETY WARNINGS AND INSTRUCTIONS. KEEP THIS ILLUSTRATION WITH THE TOOL FOR FUTURE REFERENCE. IF YOU HAVE ANY QUESTIONS, CONTACT YOUR BOSTITCH REPRESENTATIVE OR DISTRIBUTOR.

▲ADVERTENCIA:

ANTES DE LLEVAR A CABO CUALQUIER REPARACIÓN EN LA HERRAMIENTA TODOS LOS OPERARIOS DEBERÁN ESTUDIAR ESTA ILUSTRACIÓN, ASÍ COMO LA LISTA DE PIEZAS Y EL MANUAL DE OPERACIÓN Y MANTENIMIENTO. LOS OPERARIOS DEBERÁN ENTENDER Y SEGUIR TODAS LAS ADVERTENCIAS E INSTRUCCIONES DE SEGURIDAD. CONSERVE ESTA ILUSTRACIÓN CON LA HERRAMIENTA PARA PODER CONSULTARLA EN LO FUTURO. SI TUVIERA ALGUNA PREGUNTA, PONGASE EN CONTACTO CON SU REPRESENTANTE O DISTRIBUIDOR DE BOSTITCH.

AVANT DE PROCÉDER À LA RÉPARATION DE CET OUTIL, LES OPÉRATEURS DOIVENT ÉTUDIER LA PRÉSENTE ILLUSTRATION AINSI QUE LA LISTE DE PIÈCES ET LE MANUEL D'INSTRUCTIONS ET D'ENTRETIEN ; ILS DOIVENT ÉGALEMENT COMPRENDRE ET OBSERVER LES CONSIGNES DE SÉCURITÉ ET LES INSTRUCTIONS. CONSERVER CETTE ILLUSTRATION AVEC L'OUTIL POUR RÉFÉRENCE FUTURE. SI VOUS AVEZ DES QUESTIONS, COMMUNIQUEZ AVEC VOTRE REPRESENTANT OU VOTRE DISTRIBUTEUR DE BOSTITCH.

IP1225-1REV D 9/06

BOSTITCH
Stanley Fastening Systems L.P.

2625

N89C-1P

COIL-FED PNEUMATIC FRAMING NAILER

CLAVADORA NEUMÁTICA ALIMENTADA POR ROLLO

CLOUEUR PNEUMATIQUE À ENROULEMENT

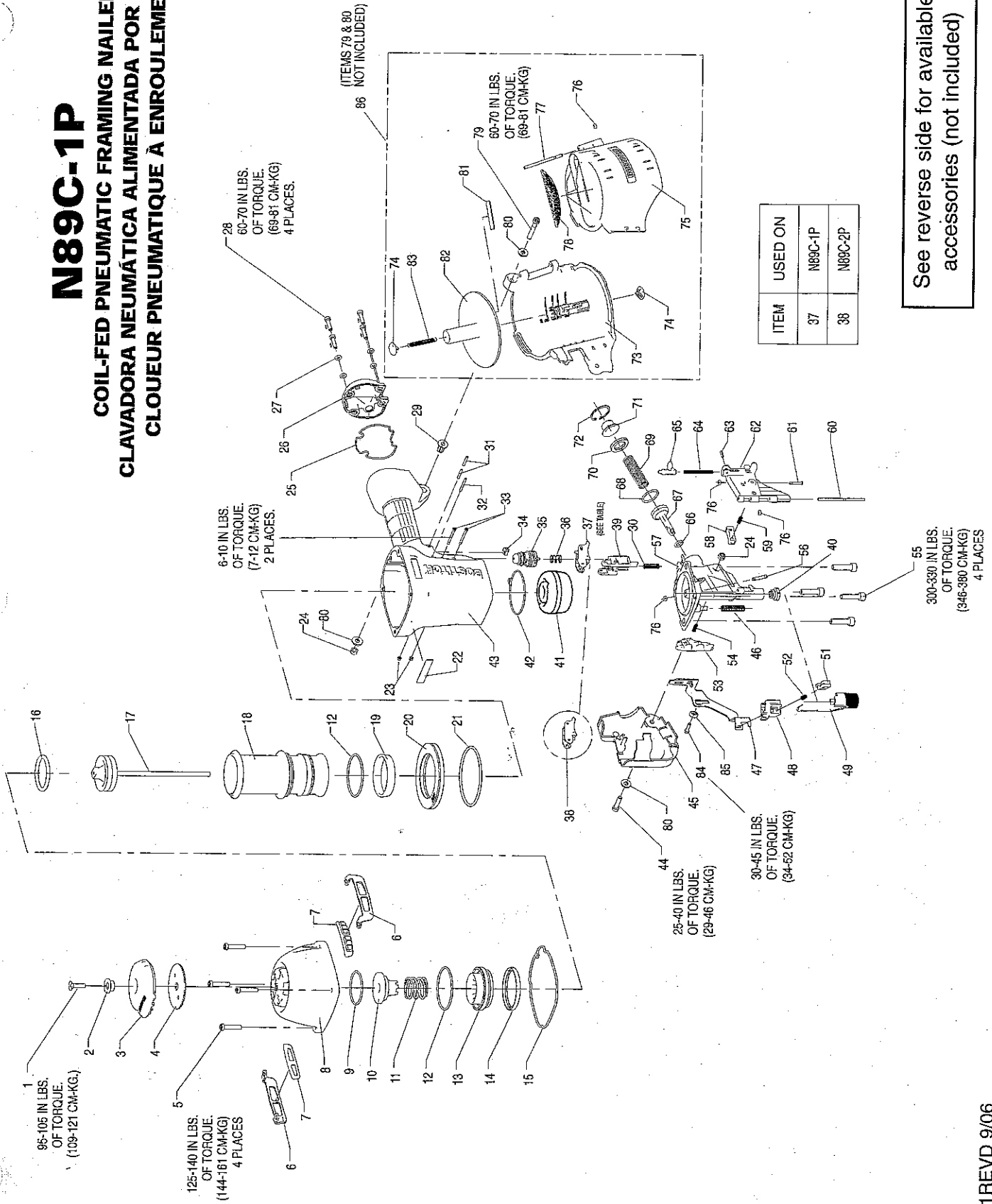

See reverse side for available accessories (not included)

BOSTITCH

N89C-1P		Parts List:		IP1225-2REVE	
To be Used with tool parts illustration:				IP1225-1REVD	
and operation and maintenance manual:				166796	
Serial Number on the Tool:				N89C-1P 6276 000 and Higher	
ITEM	PART #	DESCRIPTION	ITEM	PART #	DESCRIPTION
1	MSF6100-25	SCREW,SFHCS,M6X1.00X25	54	166774	SPRING,FEED PAWL
2	163859	BUSHING,EXHAUST DEFLECTOR	55	MSC8125-30	SCREW,SHCS M8X30
3	163818	DEFLECTOR,EXHAUST	56	166787	PIN,FEED PAWL
4	163830	PLATE,CAP	57	171121	ASSEMBLY,NOSE/WEAR BUSHING
5	MSC6100-30	SCREW,SHCS,M6X1.00X30	58	N70149	PAWL CHECK
6	163827	PLATE,WEAR	59	854011	COMPRESSION SPRING
7	149819	WEAR GUIDE	60	N80125	PIN,SPECIAL
8	163848	FRAME CAP,MACHINING	61	N70140	PIN,SPECIAL(STEP)
9	105814	O-RING,1.929X.098	62	166760	DOOR,MACHINING,N89C
10	163820	BUMPER,HEAD VALVE	63	MPG030012	PIN,SPRING,M3X12MM
11	163844	SPRING,HEAD VALVE	64	854013	SPRING,COMPRESSION
12	163822	O-RING,2.487X.103XNBR	65	N70150	LATCH DOOR
13	163821	LOWER BODY,HEAD VALVE	66	88999	O-RING,.362X.103
14	163823	SEAL,HEAD VALVE	67	163894	PISTON,FEED
15	163845	SEAL,FRAME/CAP	68	87112	O-RING,.924X.103
16	851606	O-RING,1.850X.210	69	163930	SPRING,FEED PISTON
17	163816	ASSEMBLY,PISTON/DRIVER	70	163897	STOP,FEED PISTON
18	163824	SLEEVE,CYLINDER	71	163895	COLLAR,SPRING
19	107269	SEAL,CHECK	72	163896	RETAINING RING,INCH
20	163855	RING,CYLINDER SLEEVE	73	163892	PLATFORM,CANISTER,N89C
21	108718	O-RING,3.484X.139	74	149910	CAP,NAIL TRAY
22	163881	LABEL,N89C	75	163910	COVER,CANISTER,N89C
23	MHE3050-100	NUT,NYLON M3X.50	76	854004	WASHER,RUBBER-7
24	MHE6100-100	NUT,ESN M6X1	77	166771	PIN,CANISTER COVER
25	163856	SEAL,END CAP	78	165358	LABEL,WARNING,PALLET
26	163843	END CAP,PAINT	79	MSC6100-40	SCREW,SOC. HD. CAP M6X1.00X40
27	T50118	WASHER,PLAIN	80	MPW6.2	WASHER,SPECIAL
28	MSC5080-20	SCREW,SOC HD. CAP M5 X 20	81	120927	LABEL,SENSOR SMALL (DR)
29	123859	BUSHING,FLANGED ISOLATION	82	163893	TRAY,CANISTER,N89C
30	166781	SPRING,UPPER TRIP	83	166768	SPRING,EXTENSION - CANISTER
31	MPP030020	PIN,SPIRAL M3X20MM	84	MSC4070-16	SCREW,SHCS,M4X0.7X16
32	100298	PIN,SPIRAL M3X30	85	163876	BUSHING,UPPER CONTACT ARM
33	108562	SCREW,TRIGGER PIVOT	86	166807	ASSEMBLY,CANISTER
34	164225	ACTUATOR,SMARTTRIGGER			
35	TVA6	KIT,TRIGGER VALVE			
36	100387	SPRING,COMPRESSION			
37	CNTK4	KIT,CONTACT TRIP CONVERSION			
38	SEQ7	KIT,SEQUENTIAL TRIP CONVERSION			
39	163883	GUIDE,ARM			
40	N100120	WEAR BUSHING			
41	107231	BUMPER,DRIVE			
42	163884	SEAL,NOSE			
43	171127	FRAME,OVERMOLD			
44	MSC6100-25	SCREW,SHCS,M6X1.00X25			
45	166766	COVER,TRIP			
46	116970	SPRING,CONTACT ARM			
47	163908	ARM,UPPER CONTACT			
48	163906	CASTING,HOUSING CONTACT			
49	166767	ARM,LOWER CONTACT-SMOOTH			
50	171120	NOSE,MACHINING,N89C			
51	108225	CASTING,PLUNGER			
52	115230	SPRING,HOUSING			
53	166773	PAWL,FEED,MACHINING,N89C			