

**ACCESSORIES AVAILABLE
ACCESORIOS DISPONIBLES
ACCESSOIRES DISPONIBLES**

BC601	4 oz. Bostitch Air -Tool Lubricant
BC602	1 pint Bostitch Air -Tool Lubricant
BC603	1 pint Bostitch "Winter-Formula" Air-Tool Lubricant
BC604	1 quart Bostitch Air -Tool Lubricant
851385	Loctite Grade 242 (.02 oz.)
N80K2	Remote Control Kit
121072	Softfoot
112630	Dust Shield
112631	Spring Clip for Dust Shield
N89ORK	Kit, O-ring Repair

BOSTITCH®

F28WW

**PNEUMATIC STICK NAILERS
CLAVADORA NEUMÁTICA ALIMENTADA POR BARRA
CLOUEUR PNEUMATIQUE EN BANDES**

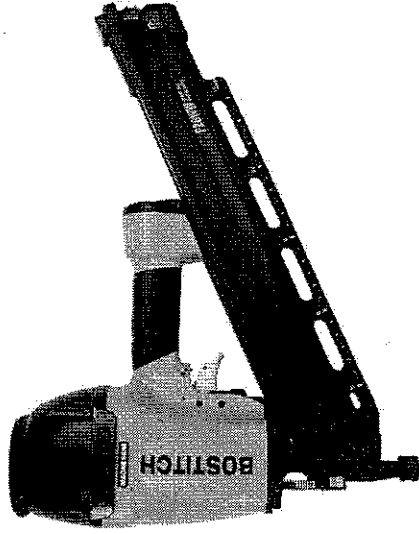

**TOOL PARTS ILLUSTRATION
ILUSTRACIÓN DE LAS PIEZAS DE LA HERRAMIENTA
ILLUSTRATION DES PIÈCES D'OUTILLAGE**

⚠ WARNING:

BEFORE PERFORMING REPAIRS ON THIS TOOL, ALL OPERATORS SHOULD STUDY THIS ILLUSTRATION, AS WELL AS THE PARTS LIST AND OPERATION AND MAINTENANCE MANUAL. OPERATORS SHOULD UNDERSTAND AND FOLLOW ALL SAFETY WARNINGS AND INSTRUCTIONS. KEEP THIS ILLUSTRATION WITH THE TOOL FOR FUTURE REFERENCE. IF YOU HAVE ANY QUESTIONS, CONTACT YOUR BOSTITCH REPRESENTATIVE OR DISTRIBUTOR.

⚠ ADVERTENCIA:

ANTES DE LLEVAR A CABO CUALQUIER REPARACIÓN EN LA HERRAMIENTA, TODOS LOS OPERARIOS DEBERÁN ESTUDIAR ESTA ILLUSTRACIÓN, ASÍ COMO LA LISTA DE PIEZAS Y EL MANUAL DE OPERACIÓN Y MANTENIMIENTO. LOS OPERARIOS DEBERÁN ENTENDER Y SEGUIR TODAS LAS ADVERTENCIAS E INSTRUCCIONES DE SEGURIDAD. CONSERVE ESTA ILLUSTRACIÓN CON LA HERRAMIENTA PARA PODER CONSULTARLA EN LO FUTURO. SI TUVIERA ALGUNA PREGUNTA, PONGASE EN CONTACTO CON SU REPRESENTANTE O DISTRIBUIDOR DE BOSTITCH.

AVANT DE PROCÉDER À LA RÉPARATION DE CET OUTIL, LES OPÉRATEURS DOIVENT ÉTUDIER LA PRÉSENTE ILLUSTRATION AINSI QUE LA LISTE DE PIÈCES ET LE MANUEL D'INSTRUCTIONS ET D'ENTRETIEN ; ILS DOIVENT ÉGALEMENT COMPRENDRE ET OBSERVER LES CONSIGNES DE SÉCURITÉ ET LES INSTRUCTIONS. CONSERVER CETTE ILLUSTRATION AVEC L'OUTIL POUR RÉFÉRENCE FUTURE. SI VOUS AVEZ DES QUESTIONS, COMMUNIQUEZ AVEC VOTRE REPRESENTANT OU VOTRE DISTRIBUTEUR DE BOSTITCH.

IP1211-1REVE 5/06

BOSTITCH
Stanley Fastening Systems L.P.

F28WW
PNEUMATIC STICK NAILERS
CLAVADORA NEUMÁTICA ALIMENTADA POR BARRA
CLOUEUR PNEUMATIQUE EN BANDES

See reverse side for available accessories (not included)

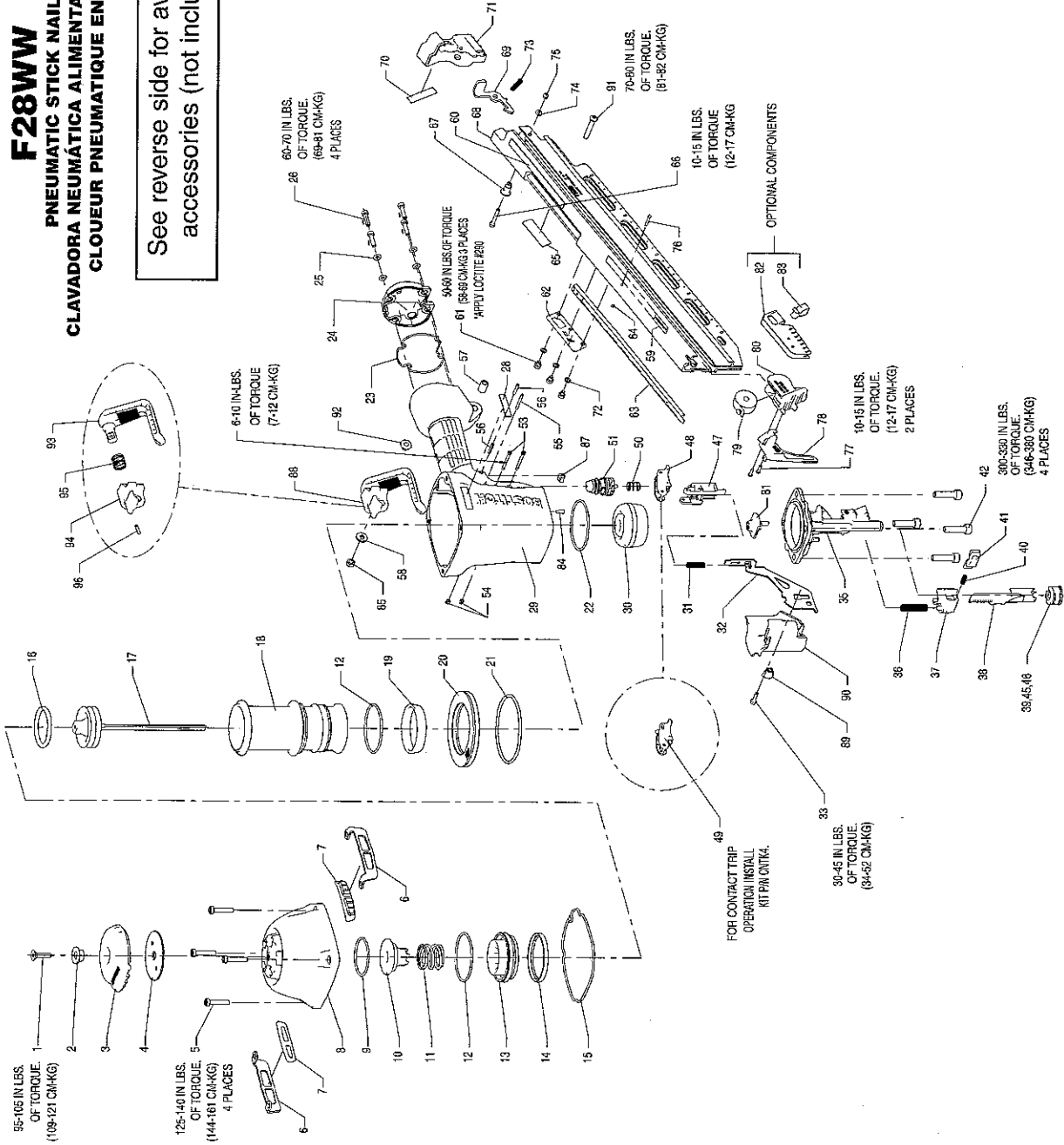

BOSTITCH

F28WW		Parts List:		IP1211-2REVH	
To be Used with tool parts illustration:					
and operation and maintenance manual:				IP1211-1REVE	
Serial Number on the Tool:				166762	
				F28WW 7010 000 and Higher	
ITEM	PART #	DESCRIPTION	ITEM	PART #	DESCRIPTION
1	MSF6100-25	SCREW,SFHCS,M6X1.00X25	59	158612	LABEL,WARNING
2	163859	BUSHING,EXHAUST DEFLECTOR	60	112789	LABEL,N88WW FASTENER SPEC.
3	163818	DEFLECTOR,EXHAUST	61	MSC5080-6	SCREW,SHCS,M5X0.80X6
4	163830	PLATE,CAP	62	163828	NUT,TEE
5	MSC6100-30	SCREW,SHCS,M6X1.00X30	63	159718	LINER,NAIL GUIDE,N88WWB
6	163827	PLATE,WEAR	64	166797	O-RING,.056X.060 NBR
7	149819	WEAR GUIDE	65	104981	LABEL,WARNING
8	163848	FRAME CAP,MACHINING	66	100261	SCREW,SHCS,M4X30
9	105814	O-RING,1.929X.098	67	121472	SPACER,PUSHER LATCH
10	163820	BUMPER,HEAD VALVE	68	166784	MAGAZINE,PAD PRINT,F28WW
11	163844	SPRING,HEAD VALVE	69	166778	LATCH,PUSHER
12	163822	O-RING,2.487X.103XNBR	70	120927	LABEL,SENSOR SMALL (DR)
13	163821	LOWER BODY,HEAD VALVE	71	116563	CAP END,MAGAZINE
14	163823	SEAL,HEAD VALVE	72	116965	WASHER,PLAIN M5
15	163845	SEAL,FRAME/CAP	73	120878	SPRING,PUSHER LATCH
16	851606	O-RING,1.850X.210	74	MPW4	WASHER,PWN,M4
17	163922	ASSEMBLY,PISTON/DRIVER	75	MHE4070-100	ELASTIC STOP NUT,M4
18	163824	SLEEVE,CYLINDER	76	121407	PIN,SPECIAL
19	175520	SEAL,CHECK	77	100209	SCREW,STRHS,M3X0.5X12
20	163855	RING,CYLINDER SLEEVE	78	158767	PUSHER,WW
21	108718	O-RING,3.484X.139	79	115143	SPRING,CONSTANT FORCE
22	89673	O-RING,2.550X.103	80	120945	HANDLE,PUSHER
23	163856	SEAL,END CAP	81	163882	GUIDE,DRIVER
24	163843	END CAP,PAINT	82	112630	SHIELD,DUST
25	T50118	WASHER,PLAIN	83	112631	SPRING,CLIP
26	MSC5080-20	SCREW,SOC HD. CAP M5 X 20	84	163858	PLUG,EXHAUST
28	116964	LABEL,MAGNESIUM	85	MHE6100-100	NUT,ESN M6X1
29	171127	FRAME,OVERMOLD	87	164225	ACTUATOR,SMARTTRIGGER
30	107231	BUMPER,DRIVE	88	171354	ASSEMBLY,UTILITY HOOK
31	166781	SPRING,UPPER TRIP	89	163903	BUSHING,TRIP COVER
32	163899	ARM,UPPER CONTACT	90	171338	COVER,TRIP
33	MSC4070-16	SCREW,SHCS,M4X0.7X16	91	MSB6100-40	SCREW,SBHCS,M6X1.00X40
35	163927	NOSE,F28WW	92	171342	WASHER,UTILITY HOOK
36	166772	SPRING,CONTACT ARM	93	171339	HOOK,UTILITY
37	108224	CASTING,HOUSING CONTACT	94	171340	MOUNT,UTILITY HOOK
38	108227	ARM,LOWER CONTACT	95	171341	SPRING,UTILITY HOOK
39	121072	ASSEMBLY,TRIP FOOT	96	UB3811.2	PIN,SPIROL - 5/32X3/4
40	115230	SPRING,HOUSING	□		
41	166777	CASTING,PLUNGER			
42	MSC8125-30	SCREW,SHCS M8X30			
45	121070	FOOT,TRIP			
46	121071	CLIP,TRIP FOOT			
47	163883	GUIDE,ARM			
48	SEQ7	KIT,SEQUENTIAL TRIP CONVERSION			
49	CNTK4	KIT,CONTACT TRIP CONVERSION			
50	100387	SPRING,COMPRESSION			
51	TVA6	KIT,TRIGGER VALVE			
53	108562	SCREW,TRIGGER PIVOT			
54	MHE3050-100	NUT,NYLON M3X.50			
55	100298	PIN,SPIRAL M3X30			
56	MPP030020	PIN,SPIRAL M3X20MM			
57	N70143	BUSHING,RUBBER			
58	MPW6.2	WASHER,SPECIAL			